

247.02.00

DT STUDIO

Lo stile marinaro è il leitmotiv della collezione Marina, nata dalla volontà di soddisfare esigenze propriamente tecniche, e sviluppatasi poi come design autonomo. La collezione include lampade da parete, applique e segnapasso dall'aspetto equilibrato, realizzate in ottone anticato.

A marine style is the leitmotif of the Marina collection, created to meet technical requirements and then developed into an independent design. The collection includes wall lights and lamps, and steplights with a balanced appearance, made of antique brass.



SPECIFICHE TECNICHE | TECHNICAL DATA

Tipologia Type	parete wall
Ambiente Environment	outdoor
Materiali Materials	Ottone Brass
Fonte luminosa Light source	1 x Max 5W LED G9 (non inclusa not included)
Tensione Voltage	240 Vac 50-60 Hz
Dimmerazione Dimming	Taglio di fase IGBT / TRIAC Phase cut IGBT / TRIAC
Scatole Boxes	1
Volume totale Total volume	0,012 m ³
Peso lordo Gross weight	1 kg
Certificazioni Certifications	CE EAC  IP55

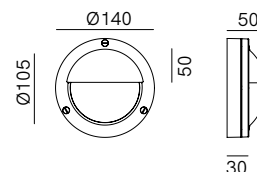

FINITURE | FINISHES

Montatura | Frame



00
Ottone Anticato
Antique Brass

Vetro | Glass

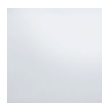

Satinato
Satin